

## Installing SNAP Rack DIN-Rail Clips

1. For long racks, slide a DIN-rail clip (or two, if needed) to a middle position and secure with the provided rivet.
2. Insert one edge of the circuit board into the extrusion.
3. Push down hard on the other edge to snap it into place.
4. Attach one DIN clip to each end cap using slots in the end caps.
5. Use provided screws to secure end cap and DIN-rail clip to each end of the extrusion.

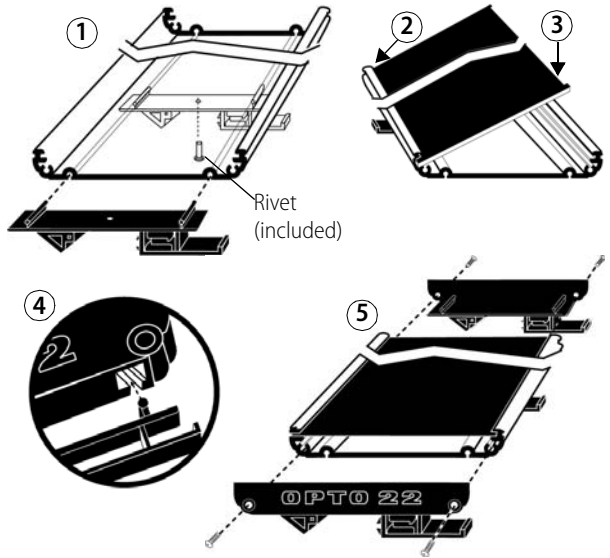

## Attaching the Adapter Clip to a DIN Rail

1. Hook the DIN-rail clip over the top of the DIN rail.
2. Using a screwdriver, pry open the DIN-rail clip flange at the bottom of the clip. Push the clip toward the DIN rail.
3. Snap the DIN-rail clip into place.

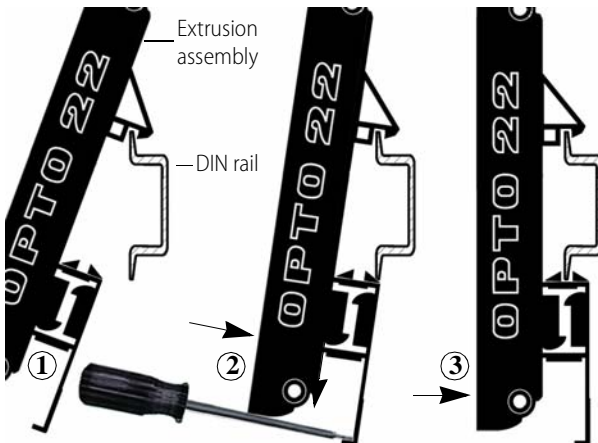

To remove the clip from the DIN rail, use a screwdriver to push the flange down, then pull the clip away from the DIN rail and unhook from the top.